

CMAA SPRING LEADERSHIP FORUM

Leading the Revolution
in Capital Projects Delivery



MAY 7–9, 2006 • SHERATON SOCIETY HILL HOTEL

PHILADELPHIA'06



Construction Management Association of America

ONSITE PROGRAM



25 YEARS

OF CONSTRUCTION MANAGEMENT

Excellence

- PROGRAM MANAGEMENT
- PROJECT MANAGEMENT
- CONSTRUCTION MANAGEMENT
- MASTER PLANNING
- CONSTRUCTABILITY REVIEW
- SCHEDULING
- COST ESTIMATING



888.912.1201
www.vanir.com

Leading the Revolution in Capital Projects Delivery

Dear Colleague:

Thank you for being part of the 2006 Spring Leadership Forum. On behalf of CMAA and the planners of this conference, I appreciate you taking the time to join us in Philadelphia and I'm confident this year's program will repay your investment handsomely.



We have an excellent curriculum of breakout sessions addressing critical current topics in management, risk, and leadership. Our keynote speaker, Lou Marines, will discuss how individuals can take action to become better leaders and promote the leadership qualities of others. The Owners' Panel will continue the CMAA tradition of lively and practical interaction with three influential construction program owners. We'll hear from Jim Creedon, secretary, Commonwealth of Pennsylvania's Department of General Services; Bill Hankowsky, chairman, president & CEO, Liberty Property Trust; and Charles Isdell Jr., director of aviation, Philadelphia International Airport.

We'll also have a chance to explore some major projects first hand through site tours of the National Constitution Center and Citizens Bank Park. And as always, we'll have plenty of opportunity to get together informally, have some fun and strengthen our networks.

Thanks again for joining us, and have a great conference!

Bob Fraga
CMAA President
Manager, Facilities Portfolio, USPS



Schedule at a Glance

Saturday, May 6

8:00 am–3:00 pm	CM Certification Exam
9:00 am–5:00 pm	CMAA Board of Directors Meeting
12:00 pm–1:00 pm	CMAA Directors/CMCI Governors Luncheon
1:00 pm–5:00 pm	CMCI Board of Governors Meeting

Sunday, May 7

8:00 am–11:00 am	CMAA Chapter Leaders Meeting
9:00 am–11:00 am	CMAA Foundation Meeting
12:00 pm–7:30 pm	Registration Open
12:30 pm–3:00 pm	CMAA Fellows Meeting
1:00 pm–5:00 pm	Chapter Tours
6:00 pm–7:00 pm	Welcome Reception
7:15 pm–11:30 pm	Baseball Game Outing

Monday, May 8

7:00 am–6:00 pm	Registration Open
7:30 am–8:15 am	Kick-Off Breakfast with "Ben Franklin"
8:30 am–10:00 am	Panel Sessions and Leadership Session
10:00 am–10:15 am	Refreshment Break
10:15 am–11:45 am	Panel Sessions and Leadership Session
12:00 pm–1:30 pm	Luncheon with Keynote Speaker Louis J. Marines
1:45 pm–3:15 pm	Panel Sessions and Leadership Session
3:15 pm–3:30 pm	Refreshment Break
3:30 pm–5:00 pm	Panel Sessions and Leadership Session
5:30 pm–6:30 pm	Networking Reception

Tuesday, May 9

8:00 am–12:00 pm	Registration Open
8:30 am–10:00 am	Panel Sessions and Leadership Session
10:00 am–10:15 am	Refreshment Break
10:15 am–11:45 am	Panel Sessions and Leadership Session
12:00 pm–1:30 pm	Closing Luncheon with Owners Panel

2006 Spring Leadership Forum Committee

CHAIR:

Ron Kerins, CCM
Faithful + Gould

MEMBERS:

Christine Flaherty, CCM
STV Construction, Inc.

Raju Kaval, CCM
Los Angeles Unified School District



Credit for Professional Development

CMAA University provides registrants with professional development credit for each education session attended. In order to meet the varied formats for reporting mandated education requirements to licensing boards, credits are identified in both Professional Development Hours (PDH) and Continuing Education Units (CEUs). In addition, CMAA is registered with the American Institute of Architects (AIA) as an approved provider of Learning Units (LU). Conference attendees may earn and report up to 12.75 PDH, 1.275 CEU, and 12.75 LU from participating in the conference. Electronic transcripts and AIA reports are available by request. CCMs can also earn two (2) points towards CMCI re-certification by attending this conference.



Sunday, May 7, 2006

CMAA Fellows Meeting

12:30 pm–3:00 pm

Cook Room

The Fellows will meet to discuss items of importance to the program.

Citizens Bank Park Tour

1:00 pm–3:30 pm

Depart from the hotel lobby

Before going to the baseball game tonight, take a special, behind-the-scenes tour of Philadelphia's famed ball park, the Citizens Bank Park, with the guidance of a construction manager from the project.

\$45 per person. Fee includes transportation and admission.

National Constitution Center and Independence Mall Tour

1:00 pm–4:00 pm

Depart from the hotel lobby

On July 4, 2003, the City of Philadelphia opened the doors to the National Constitution Center (NCC). The NCC tells the story of the U.S. Constitution through more than 100 interactive multimedia exhibits, photographs, sculptures, text, film and artifacts.

The CMAA Mid-Atlantic Chapter hosts this walking tour. The tour will be led by David Rupp of Hill International Inc., project manager for the design and construction of the NCC.

\$20 per person. Fee includes NCC entrance fee.

Welcome Reception

6:00 pm–7:00 pm

Hamilton Room

This reception held at the host hotel provides the attendees with an opportunity to mingle, catch up with old friends and meet new ones before going out to sample one of Philadelphia's famous restaurants for dinner. Be sure to attend and start the Spring Forum off right!

Reception co-sponsored by McDonough Bolyard Peck, Inc. and PSOMAS.

Philadelphia Phillies vs. San Francisco Giants

7:15 pm–11:30 pm

Depart from the hotel lobby

Take me out to the ball game! The Phillies are playing at home against the Giants. Take this opportunity to see this legend in the game play at one of the premier stadiums in the country. And you can root for your host city against the Giants. After CMAA's Welcome Reception, you will board the bus at 7:15 pm for a short ride to the stadium, giving you plenty of time to grab a beverage and a snack and then settle in your seat.

\$35 per person. Fee includes ticket to the game, a snack and bus transportation.

Transportation and snack sponsored by CMAA Mid-Atlantic Chapter.

Monday, May 8, 2006

Kick-Off Breakfast • 7:30 am–8:15 am • Ballroom C–E

President Bob Fraga and Spring Leadership Forum Chairman Ron Kerins, CCM, will join in opening the Spring Forum and welcoming the attendees.

As a special treat, Ben Franklin will join the general session to tell the stories of the beginnings of this nation and the importance of building trades in getting America off to a grand start. This humorous, fast-paced historic presentation will inspire you through the anecdotes about America's founding fathers.

Ben comes alive as a creation of Ralph Archbold, the leading Franklin portrayer in the world, having spoken before more than 15,000 groups in the character of Benjamin Franklin over the past 33 years.



Breakfast sponsored by HNTB Corporation.

8:30 am–10:00 am

#PA6RP1

Project Risk Assessment—Adding a New Dimension to Predicting the Future

Ballroom B

TRACK: Risk

MARKET SECTORS: Education, Utilities, Public Safety, Water Supply/Waste Water, Private Office, Highways, Industrial Buildings, Telecommunications, Healthcare Facilities, Hotels/Motels, Transportation

The panel will define what project risk assessment is, what it is not, what outcomes can be expected, and why it's done. A recommended approach to risk analysis will be presented based upon an approach undertaken by the Federal Transit Administration to ensure the likelihood of its capital projects being completed on time and within budget.

MODERATOR: Janet Cunningham, PE, president, JBC Associates, Inc.

PANELISTS: Ali Touran, PhD, PE, professor, Northeastern University; Susan Schruth, Federal Transit Administration; Brian A. Stover, CCM, PE, senior vice president, Urban Engineers; Veronique Hakim, vice president and general counsel, MTA Capital Construction

#PA6MP1

Using Best Value Techniques to Select Subcontractors

Ballroom A

TRACK: Management

MARKET SECTORS: Education, Utilities, Public Safety, Water Supply/Waste Water, Private Office, Highways, Industrial Buildings, Telecommunications, Healthcare Facilities, Hotels/Motels, Transportation

Delivery methods must focus on greater collaboration instead of being adversarial. This panel will discuss why CMs should incorporate the collaborative best value delivery method with the conventional CM approach to provide better performance, better value, less risk and improved quality for all project stakeholders.

MODERATOR: Ted Garrison, president, Garrison Associates

PANELISTS: Harry M. Perks, principal, Perks Reutter Engineering; James D. Hollyday, partner, Pepper Hamilton, LLC.; Dean T. Kashiwagi, PE, director, Arizona State University, Performance Based Studies Research Group; Nathan B. N. Chong, PE, chief, U.S. Army Medical Command

#PA6LD1

Principles and Challenges of Leadership

Claypoole/Bromley Room

TRACK: Leadership

MARKET SECTORS: Education, Utilities, Public Safety, Water Supply/Waste Water, Private Office, Highways, Industrial Buildings, Telecommunications, Healthcare Facilities, Hotels/Motels, Transportation

The Principles and Challenges of Leadership will provide basic information about the science and technology of leadership, the characteristics of people that make the leadership role a challenge to fulfill, and will provide a foundation for other discussions and sessions in the Leadership Track.

PRESENTER: Megan Neyer, PhD, consultant, Advanced Management Institute

10:00 am–10:15 am

Refreshment Break

Ballroom Foyer

Sponsored by CH2M HILL

10:15 am–11:45 am

#PA6RP

Revolutionary Scheduling: The Practical Application of 4D Technology from a CM Perspective

Ballroom B

TRACK: Risk

MARKET SECTOR: Institutional Facilities

This session will introduce a revolutionary technology that will enhance the traditional agency CM role in project delivery. A panel consisting of a CM practitioner, an owner, and an academician will present their perspective on the features and benefits of 4D technology.

MODERATOR: Brian Koches, CCM, manager of projects, Jacobs Facilities

PANELISTS: John A. Morrell, project manager, U.S. General Services Administration; Mera Faddoul, PE, project manager, Jacobs Facilities; John I. Messner, PhD, assistant professor, The Pennsylvania State University

#PA6MP2

Lease-Leaseback

Ballroom A

TRACK: Management

MARKET SECTOR: Education

When was the last time a contractor wrote you a check after the project was complete? Lease-leaseback is an innovative procurement strategy that allows the owner to conserve resources while selecting a winning project team. Participate in a discussion with a winning team that includes the owner, project manager, and leaseback contractor who are building new public schools and modernizing existing educational facilities in California.

MODERATOR: Mark Claussen, program director, PinnacleOne/Barnhart

PANELISTS: Brian Cahill, executive vice president, Douglas E. Barnhart, Inc. and Doug Mann, executive director facilities, Poway Unified School District



Monday, 10:15 am–11:45 am (cont.)

#PA6LD2

Real World Leadership

Claypoole/Bromley Room

TRACK: Leadership

MARKET SECTORS: Education, Utilities, Public Safety, Water Supply/Waste Water, Private Office, Highways, Industrial Buildings, Telecommunications, Healthcare Facilities, Hotels/Motels, Transportation

The panel session will focus on real work situations where a leadership principle can be demonstrated. Examples will be taken from a current unnamed project that was undergoing severe stress on and between the project team participants. The situation was viewed as very serious by senior officials who determined change was required. The presentation will also focus on the roles of the parties and the need to provide a positive impact on project success.

MODERATOR: Robert Hixon, CCM, FCMMA, project executive, Architect of the Capitol

PANELISTS: William McLaurin, Grinnell Leadership, Inc. and John Tarpey, president, Centex Construction Company

1:45 pm–3:15 pm

#PA6RP3

Managing Materials Cost Escalation

Ballroom B

TRACK: Risk

MARKET SECTORS: Education, Utilities, Water Supply/Waste Water, Highways, Transportation

Early in 2004, the U.S. experienced rates of escalation affecting steel, concrete, wood, and subproducts of these materials not seen in many years. In the aftermath, this was attributed to Chinese mass consumption and to a Florida hurricane. Last year, two more city-devouring hurricanes might have further contributed to materials price escalation. This panel, comprising industry experts on the side of an owner, CM, general contractor, and legal counsel to the industry, will summarize the impact on the industry, and address the impact within their areas of influence. The panel will prompt audience participation as it offers viable courses of action.

MODERATOR: W. Scott Harral, CCM, regional director, Towill, Inc.

PANELISTS: Joseph Seibold, vice president, PinnacleOne; Porie Saikia-Eapen, RA, chief architect, New York City Transit; Daniel Shovlin, operations director, Faithful + Gould; B. Christopher Lee, Esq., managing shareholder, Jacoby Donner, P.C.

#PA6MP3

A New Revolution in Massachusetts

Ballroom A

TRACK: Management

MARKET SECTOR: Public Sector Construction

On July 19, 2004, the Lieutenant Governor signed legislation revolutionizing public design and construction in Massachusetts. MGL Chapter 193 enables public agencies and awarding authorities to employ new contracting methods for design and construction, modifies designer selection procedures, mandates contractor prequalification and certification, and mandates an owner's project manager on state-assisted projects. The panelists, all involved in its development, will provide their insight and discuss the potential impacts on other states.

Luncheon with Keynote Speaker

Louis L. Marines • 12:00 pm–1:30 pm • Ballroom C–E



Following the luncheon, **Louis L. Marines**, president of Advanced Management Institute for Architecture and Engineering (AMI), will be the featured keynote speaker. Lou is a widely respected authority on leadership development in the A/E/C industry. He was a Phi Beta Kappa graduate of Washington & Jefferson College and also attended the Harvard Graduate School of Business Administration and the Wharton School. During his career, Lou worked as a principal of the Coxe Groups, Inc., from 1972–77; was an instructor in management and marketing at the Drexel University of Architecture during that same time; served as vice president and general manager of William Kessler & Associates from 1977–1978; and from 1978–1984 held the position of general manager of Haines Lundberg Waehler (now HLW International LLP). Lou was then selected to be the chief executive officer and board

member of the American Institute of Architects in Washington, DC, a position he held from 1984–1989.

To use his experience, he founded AMI in 1989 to provide executive education in leadership and management skills through customized in-firm education and public programs. AMI now consults to the A/E industry on a wide range of management and training issues. Under Lou's leadership, AMI created the industry's first Chief Operating Officers and Chief Learning Officers forums. He was a key participant in creating the executive development program for the American Council of Engineering Companies, plus the creation of AIA's corporate university for its 50 largest firms.

Luncheon sponsored by PinnacleOne.

MODERATOR: Stephen F. Rusteika Jr., senior principal/practice group leader, PMA Consultants LLC

PANELISTS: Maureen McDonough, assistant director, Massachusetts Port Authority; Michael L. McKimney, PE, deputy director, Division of Capital Asset Management, Commonwealth of Massachusetts; Robert L. Petrucelli, president and chief executive officer, Associated General Contractors of Massachusetts

#PA6LD3

Determining Your Leadership IQ

Claypoole/Bromley Room

TRACK: Leadership

MARKET SECTORS: Education, Utilities, Public Safety, Water Supply/Waste Water, Private Office, Highways, Industrial Buildings, Telecommunications, Healthcare Facilities, Hotels/Motels, Transportation

This session will provide and demonstrate information about the science and technology of assessing leadership preferences and potentials. People will be led to understand their personal characteristics and level of leadership development, and how it can relate to their effectiveness as leaders of capital projects.

PRESENTER: Megan Neyner, PhD, consultant, Advanced Management Institute

3:15–3:30 pm

Refreshment Break

Ballroom Foyer

3:30 pm–5:00 pm

#PA6RP4

Managing Schedule Impacts or What to Do When Mr. Murphy Comes-a-Calling?

Ballroom B

TRACK: Risk

MARKET SECTORS: Highways, Transportation, Airports, Bridges

When a schedule is impacted, the knee-jerk answer to recovery of time is to increase resources. The implementation of such a limited recovery strategy often yields minimal upside results for the money spent, and can even result in unintended additional delay and time-related

costs. In this session, our presenters will discuss sensible, proactive measures that the owner can implement to minimize the probability of project delays, manage delays when they do arise, and mitigate the time and costs impacts on project delivery.

MODERATOR: William Brad Arnhart, PE, associate vice president, HNTB Corporation

PANELISTS: Ewa Z. Bauer, PE, deputy district engineer Golden Gate Bridge and highway and transportation district project manager Golden Gate Bridge Seismic Retrofit; Felix Periera, AIA, chief, north terminal development facilities division Miami-Dade aviation department, Miami International Airport; James C. Thompson Jr., vice president & general counsel, Alpha Corporation; Fred Schneader, senior project manager, HNTB Corporation

#PA6MP4

Back-to-Basics Approach to Program Management

Ballroom A

TRACK: Management

MARKET SECTORS: Education, Utilities, Public Safety, Water Supply/Waste Water, Private Office, Highways, Industrial Buildings, Telecommunications, Healthcare Facilities, Hotels/Motels, Transportation

Back-to-Basics empowers project teams to look beyond their areas of expertise and contribute to the goals of the project. Many feel that we have deviated from the original concept by becoming too specialized. Panel members are challenged to define their roles and boundaries in adopting this approach as they explore better and more cost effective solutions that lead to delivering projects with more added value and shorter schedules.

MODERATOR: Mysore L. Nagaraja, president, MTA Capital Construction

PANELISTS: Raymond Finnegan, PE, project director, Parsons Brinckerhoff/Bovis Lend Lease JV; Dave Donatelli, PE, senior vice president, Parsons Brinckerhoff Quade & Douglas, Inc.; Joseph P. Gildner, PE, deputy director – Link Light Rail, Sound Transit Link

Monday, 3:30 pm–5:00 pm (cont.)

#PA6LD4

Leadership at the Project Level

Claypoole/Bromley Room

TRACK: Leadership

MARKET SECTORS: Education, Utilities, Public Safety, Water Supply/Waste Water, Private Office, Highways, Industrial Buildings, Telecommunications, Healthcare Facilities, Hotels/Motels, Transportation

The session will identify the needs for leadership at various levels within the CM firm, with special attention to the need for leadership at the project level. Panel members will provide real-life examples of how and why they employ various leadership techniques, and how they believe such leadership can add dollars to the “bottom line” for companies.

MODERATOR: Chris Reeseigh, FCMAA, president, Parsons Brinckerhoff Construction Services

PANELISTS: Dennis Dunne, FCMAA, independent consultant and Ron Pennella, senior account executive, StructureTone

Networking Reception

5:30 pm – 6:30 pm

Hamilton Room

This reception caps the first day of the Spring Forum. The panel and leadership sessions, along with the keynote speakers' comments, provide great topics for conversation while networking with fellow attendees. Stop in, have a bite to eat and a beverage, and set up your plans for the evening as you mingle.

Reception co-sponsored by Constructware and Urban Engineers.

Tuesday, May 9, 2006

8:30 am–10:00 am

#PA6RP5

Organizing Chaos: Managing Continuous Building Programs

Ballroom B

TRACK: Risk

MARKET SECTORS: Education, Utilities, Public Safety, Water Supply/Waste Water, Private Office, Highways, Industrial Buildings, Telecommunications, Healthcare Facilities, Hotels/Motels, Transportation

Program managers are dealing with issues of outsourcing, rotating project workflow into project activities, developing economies of scale, continuous improvement, and restructuring the project delivery process. Join this candid discussion by industry leaders on emerging trends and how program management is growing throughout the U.S.

MODERATOR: Blake Peck, CCM, FCMAA, executive vice president, McDonough Bolyard Peck, Inc.

PANELISTS: William Hoy, senior vice president—construction, B.F. Saul Company; Robert Fraga, manager, facilities portfolio, U.S. Postal Service; Robert Hixon Jr., CCM, FCMAA, project executive, Architect of the Capitol; and Charles Thomsen, FCMAA, chairman, 3D/I

#PA6MP5

Collaboration: The Key to Resolving Claims and Avoiding Disputes

Ballroom A

TRACK: Management

MARKET SECTORS: Education, Utilities, Public Safety, Water Supply/Waste Water, Private Office, Highways, Industrial Buildings, Telecommunications, Healthcare Facilities, Hotels/Motels, Transportation

Contractors and owners tend to treat the change order and claims process as adversarial rather than one that embodies the spirit of mutual problem solving between the parties. Often because of this adversarial atmosphere, change orders and claim issues begin as a dispute waiting to happen. This panel will explore how the difference between the owner's view and the contractor's view of contractor claims perpetuates this adversarial mentality. We will also explore innovative ways of making this process more collaborative and thus enabling the parties to successfully deal with these issues on a contemporaneous basis thereby avoiding the need to resort to formal adjudication.

MODERATOR: Gary H. Jentzen, P.E., J.D., managing principal, PMA Consultants LLC

PANELISTS: Richard Martone, senior principal, PMA Consultants LLC, and Phil Beck, Esq., Smith, Currie & Hancock

#PA6LD5

Designing and Managing Your Personal Leadership Development Programs

Claypoole/Bromley Room

TRACK: Leadership

MARKET SECTORS: Education, Utilities, Public Safety, Water Supply/Waste Water, Private Office, Highways, Industrial Buildings, Telecommunications, Healthcare Facilities, Hotels/Motels, Transportation

This session will provide individuals with solid rationales for developing such programs. It will also identify components of effective programs, explain how programs can be tailored to meet the individual's needs and resources, and explain how the individual can evaluate their own progress.

PRESENTERS: Don B. Russell, CCM, FCMAA, director, Vanir Construction Management, Inc. and Megan Neyer, PhD, consultant, Advanced Management Institute

10:00 am–10:15 am

Refreshment Break

Ballroom Foyer

10:15 am–11:45 am

#PA6RP6

Who Survives the Perfect Storm? Risk Avoidance vs. Proper Risk Assessment and Management

Ballroom B

TRACK: Risk

MARKET SECTORS: Education, Utilities, Public Safety, Water Supply/Waste Water, Private Office, Highways, Industrial Buildings, Telecommunications, Healthcare Facilities, Hotels/Motels, Transportation

Public and private owners may draft contracts for capital projects that are designed to shield the owner from all liability for additional project costs and to shift that entire risk to the contractor. This ultimate risk-avoidance strategy, however, may leave the project without an owner or any other party, who is willing or able to employ sound construction management principles. This session will illustrate the effect of improper risk avoidance on capital projects, explore the interplay between risk shifting and sound construction management, and demonstrate risk management techniques that are necessary to deliver a successful capital project.

MODERATOR: Christopher Brasco, Esq., partner, Watt, Tieder, Hoffer & Fitzgerald, LLP

PANELISTS: Mark Sgarlata, Esq., partner, Watt, Tieder, Hoffer & Fitzgerald, LLP; Kathleen Olden Barnes, Esq., partner, Watt, Tieder, Hoffer & Fitzgerald, LLP; Chris Anzidei, Esq., partner, Watt, Tieder, Hoffer & Fitzgerald, LLP; Blake Peck, CCM, FCMAA, executive vice president, McDonough Bolyard Peck, Inc.

#PA6MP6

Building Information Modeling (BIM)—Revolutionizing Project Delivery

Ballroom A

TRACK: Management

MARKET SECTOR: Vertical Construction

The session will begin with an introduction of Building Information Modeling (BIM) to demonstrate the capabilities of this new and emerging technology “tool.” The participants will then be queried on the challenges they face in project delivery to meet tighter schedules, smaller budgets, higher quality standards, and company profit objectives. Panelists will then be engaged to provide commentary on how BIM can respond to these challenges today and how it can be developed in the future.

MODERATOR: Rob Smedley, AIA, director of architecture, The Onyx Group

PANELISTS: Lorraine Kay, president, Kay Construction; Matt Bonzella, project manager, Tuckman-Barbee Construction Company, Inc.; Dick Charleson, director national building group, Walsh Group; Judith M. Kunoff, AIA, LEED-AP, senior project manager, Parsons Brinckerhoff, Inc.

#PA6LD6

Cost-Effective Leadership Development Programs

Claypoole/Bromley Room

TRACK: Leadership

MARKET SECTORS: Education, Utilities, Public Safety, Water Supply/Waste Water, Private Office, Highways, Industrial Buildings, Telecommunications, Healthcare Facilities, Hotels/Motels, Transportation

This session will discuss solid rationales for developing leadership programs, identify components of effective programs, and explain how programs can be tailored to meet both the requirements for a company's leadership needs as well as the requirement for affordability at the corporate level.

PRESENTER: Don B. Russell, CCM, FCMAA, director, Vanir Construction Management, Inc.

Closing Luncheon with Owners' Panel

12:00 pm–1:30 pm

Ballroom C–E

As a close to the Forum, a panel of owners will focus their “looking glass” and describe the future of how they see projects being led. Part of the dialogue will include the natural and necessary topic of the management of “risks” for the owner along a project's time line. The following individuals will comprise the panel: William Hankowsky, chairman, president and CEO of Liberty Property Trust; James Creedon, secretary of the Commonwealth of Pennsylvania Department of General Services; and Charles Isdell Jr., director of aviation of the Philadelphia International Airport. The panel discussion will be moderated by Ron Kerins, CCM, of Faithful + Gould, and Mike Griffin of Hill International, Inc.

Full page ad
Hill International

Sheraton Society Hill Hotel Site Map

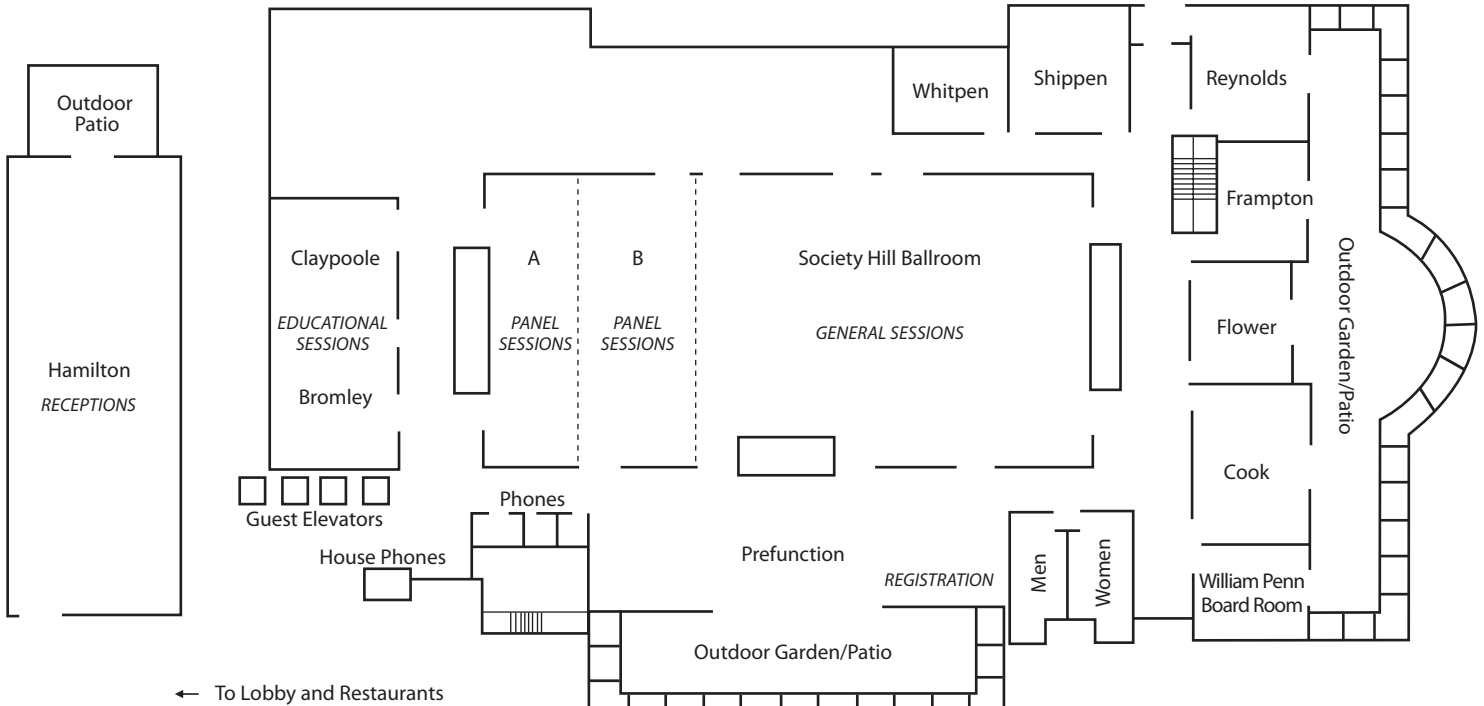

Meeting Information

Cell Phone Etiquette

As a courtesy to your fellow conference attendees, when you're in a formal setting such as the discussion forums, education sessions, or general sessions, please turn off your cell phone or set it to vibrate. CMAA appreciates your cooperation with this request.

Conference Attire

Business casual

Responsible Drinking Policy

Recognizing the emphasis on receptions and the potential for alcohol abuse, CMAA has issued a statement encouraging responsible drinking. Supporting this policy, all CMAA-sponsored receptions will offer non-alcoholic drinks. Alcohol will not be served to anyone under the age of 21.

CMAA Bookstore

Don't miss this chance to browse through publications you've been interested in purchasing from CMAA. The entire selection of titles is available for pre-ordering at the registration area beginning on Sunday at noon. The books you order onsite will include a 10% price discount and will be shipped after the Spring Forum at no charge to you – so take advantage of this money-saving offer!

Forum Abstracts

The abstracts from the sessions will be distributed following the forum. A special CD package will include summaries of the 12 panel sessions and the six leadership sessions.

Registration

Check your registration materials carefully to be certain you have the proper meeting credentials: badge, badge holder and lanyard, and tickets. You will also receive the onsite program, a highlighter, and a registrant list. Confirm you have the correct purchased tickets.

Badges will be checked for entry into all non-ticketed forum events, therefore, it is important that badges be worn at all times. Those persons not wearing appropriate forum badges can be turned away. Lost badges can be replaced for a \$10 fee. Tickets will be collected at all events requiring ticket purchase. Lost or stolen tickets are not replaceable; re-purchase is required.

Lanyards sponsored by Keville Enterprises, Inc. Highlighters sponsored by Kay Construction. Onsite program co-sponsored by Hill International, Inc. and Vanir Construction Management, Inc. Registrant list sponsored by URS Corporation. Conference signage sponsored by PBS&J.

Sponsors (as of April 7, 2006)

Through sponsorships, the following firms are helping to enhance several of the events at the Spring Leadership Forum. A special thanks from CMAA to all participating firms for their support.

Gold Level (\$5,000–\$9,999)

PinnacleOne

Silver Level (\$3,000–\$4,999)

HNTB Corporation

Bronze Level (\$1,500–\$2,999)

Constructware

Hill International

Keville Enterprises, Inc.

McDonough Bolyard Peck, Inc.

PBS&J

PSOMAS

Urban Engineers

URS Corporation

Vanir Construction Management, Inc.

Friend Level (\$1,499 and under)

CH2M HILL

CMAA Mid-Atlantic Chapter

Kay Construction